

# THE LEARNING CIRCLE

by Loren Woerpel, Noc Bay Trading Company

## JINGLE DRESS CONES

These instructions apply to making cones from the pre-cut "snuff can" lids currently available today. The lids are flat, so there is no need to trim edges off.

The cones should be made with a large enough top hole so that the fabric fringe already sewn onto the dress in the desired pattern can be knotted and inserted into the top of the cone. With the knot all the way inside, the top of the cone is crimped shut with a regular long nosed pliers.

**SAFETY FIRST** though when making these cones! We suggest using gloves when cutting and bending cones. Leather gloves would provide the best protection, but use cotton gloves if that is all that is available. Be careful of sharp scraps and the cut edges of the lids.

Equipment needed are a small tin shears, or an old pair of scissors that won't be used for cloth cutting after cutting your cones. Cones may be turned by using a long nosed pliers, but we recommend the new cone turning tools. They are available in both wood and metal. The metal tools will last for thousands of cones, the wood for hundreds.

These instructions will help you make cones with the cone turning tools. Instructions are written for right hand people. Left handed folks need to reverse.

The first step is to trim off the edge of the lid as in Figure 1. The cut is made from about the 1 O'clock position to the 4 O'clock position if this were a clock.

Next insert that straight edge into the slot of the cone turning tool as shown in figure 2. Positioning this tip of the tool lower or higher on this edge will change the size of the hole in the top of the cone. Start with the cone level with the top of the lid and adjust it if needed to change the size of the hole.



Step 1

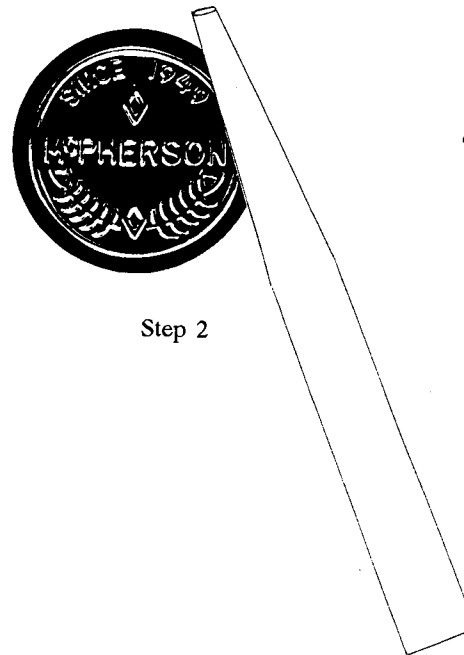

Step 2



Step 4

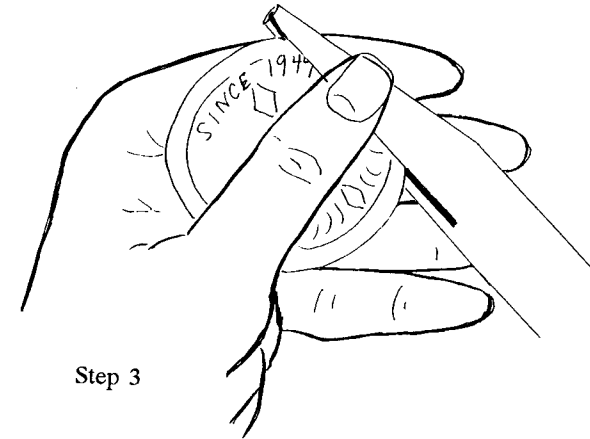

Step 3

With the cone tool in your right hand, the thumb of your left hand pressed on the top of the lid and the fore finger supporting the cone tool beneath, slowly twist the tool in a clockwise direction. As you do this continue to press hard with your thumb. Having rotated the lid into a cone, release the tool by wiggling it and pulling it out of the cone.

Carefully dispose of all the trim scrap pieces to avoid injury to anyone.

Copyright: 1995 by Loren Woerpel  
Noc Bay Trading Company  
PO Box 295  
Escanaba, Michigan 49829